

# QUEST X1

## QUICK START GUIDE

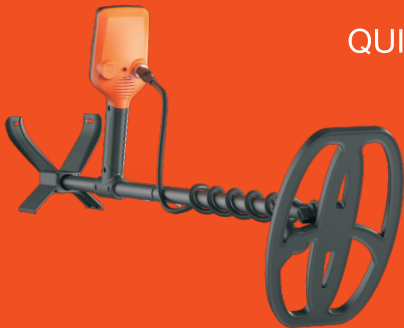

### PACKAGE INCLUDE:

- 1X TurboD Blade Coil
- 1X Coil Cover
- 1X Control Box with handle
- 1X Shaft Set (3 sections)
- 1X Armrest Set (2 pieces)
- 1X USB Type-C Cable
- 1X Quick Start Guide

Version: 202312X1\_EN

# STEP 1 SHAFT SETUP

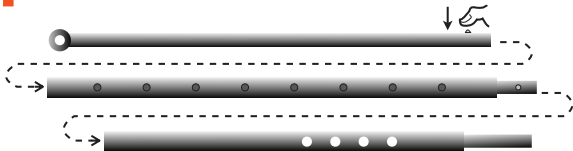

For adult



For junior



STEP  
**2**

## HANDLE & ARMREST

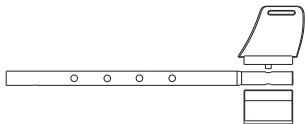
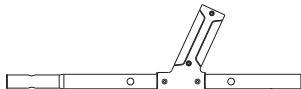
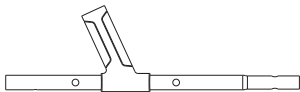

# STEP 3 COIL ROUTING



Fig 1



- Wrap the coil cable to the shaft from the lower part.
- Pay attention to the spiral direction.
- Leave certain length at the tilting part to avoid damage when folding the coil.
- Match the connector, push in and tighten the ring(Fig 1).



#### Control

- 1 Power/Menu
- 2 Pinpoint
- 3 + - sensitivity
- 4 Ground balance
- 5 Speaker volume
- 6 Flashlight

#### Display

- A Target ID Segment
- B Digit target ID
- C Battery level
- D Audio level
- E Sensitivity
- F Depth
- G Search Mode

## QUICK START

- Press power button once to **power on X1**. Hold to power off.
- Press arrow up/down to increase or decrease sensitivity.
- Press menu button once to change detection mode.
- Hold pinpoint button and xing target to locate find.
- Hold and pump coil above ground to balance.

Or search "Quest X1 tutorial" on YouTube for more tips

# YOUR VOICE

PLEASE TAKE A FEW MOMENTS TO ANSWER OUR QUESTIONS. THEY WILL HELP US DEVELOP NEW PRODUCTS FOR THE FUTURE.

1 Why did you decide to buy a Quest detector?

- Detection performance
- New technology / Features.
- Style / Design
- Ergonomic / Weight
- Recommendation
- Promotion

2 Your age group?

- 18~25
- 26~36
- 37~55
- 56+



# DETECTING



## SWING

Swing the coil approx 4cm above the ground. Overlap the last swing to avoid missing any target.



## XING

When you hear a confident high tone, press and hold the pinpoint button to locate the target precisely.



## PINPOINTING

Use a Xpointer to help you find the target faster. Simply use the tip of the Xpointer to "sniff" the target covered by dirt.



## DIGGING

Use a Digger to dig out the soil. Try to keep the dig pattern as small as possible. Remember to cover it when you finish.



## HEADPHONES & RECHARGE



Take off moisture and dust cover to access ports. Put it back to place to avoid damage by liquid or dirt.



You can use headphones, earphones with 3.5mm diameter type connector. Set to low audio volume before wear your headphones to avoid hearing damage.

04:00Hr FULL



Connect the USB Type-C cable to a wall charger with USB port. The battery indicator will stop flashing when fully charged. Please allow 4 hours to refresh the X1.





# UNDERSTANDING

## TARGET ID & INDICATION SEGMENTS

X1 categorize metal signals into different digit from 1 to 9 based on the conductivity range. The high conductivity the higher digit you will get from the display. For better visualize effect we use indication bars to indicate which area the metal fall into. For example a US quarter or silver coin will be indicated as 8 together with the fifth bar. The detection and processing system will be affected by soil condition, trashy metal items. Depends on the strength of signal the detector indicates the depth of the target.



## TONES

X1 output high tone, middle tone and low tone depends on the target ID so you can use your ear to make quick decision. Most experienced detectorists use this technics.

## PROGRAMS

- **Coin Mode.** Very stable, medium recovery speed, target for ancient or modern coins TID range 4 - 9
- **Jewelry Mode.** Very sensitive, high recovery speed, target at Gold rings, Jewelry items. TID range 2 - 9
- **All Metal Mode.** High recovery speed, ZERO discrimination, good for gold prospecting. TID 0-9

## GROUND BALANCE

Different soil mineralization may vary. Ground balancing helps to remove or reduce the ground effect noise and be more focused on the real target.



# PRODUCTS CARE

**NOTICE!** Do not twist the coil tail and connector to avoid wire damage.

**NOTICE!** Do not store the device where prolonged exposure to extreme temperatures can occur to avoid device damage.

**NOTICE!** Never use a hard or sharp object to operate the touch pad, or damage may result.

**NOTICE!** Avoid chemical cleaners, solvents, and insect repellents that can damage plastic components and finishes.

**NOTICE!** Secure the weather cap tightly to prevent damage to the USB port.

**NOTICE!** Even small amounts of sweat or moisture can cause corrosion of the electrical contacts when connected to a charger.

## Clean the detector

- Wipe the device using a cloth dampened with a mild detergent solution.
- Wipe it dry. After cleaning, allow the device to dry completely.
- Use a soft, clean, lint-free cloth. If necessary, lightly dampen the cloth with water.
- If using a dampened cloth, turn off the device and disconnect the device from power.
- Gently wipe the screen with the cloth.
- It can withstand heavy rain. Submersion in water can cause damage to the device.



## TROUBLESHOOTING

<b>NOT POWER ON</b>	No power, please recharge.
<b>NO ALARM / OVERLOAD</b>	Coil not connect to the control box
<b>VERY NOISY / FALSING</b>	Please find another place with less interference
<b>NO SOUND</b>	Make sure the Volume is not ZERO level
<b>FALSING WHEN SEARCHING IN GRASS</b>	Please confirm the coil cable is not broken

Date Of Purchase

MM / DD / YY

Serial Number

Model Name

Surname

Title

First Name

Address

Zip Code

Email

Telephone

We'd like to tell you about new Quest products and services or get your opinion about your purchase. If you'd prefer us NOT to keep in touch, please tick this box.

**REGISTER DETECTOR ONLINE IS EASY**  
Go to [QuestMetalDetectors.com](http://QuestMetalDetectors.com), Click **SUPPORT** and scroll down to **REGISTRATION**.  
If you need help please mail your info to [info@questmetaldetectors.com](mailto:info@questmetaldetectors.com) and we will input for you.